

# SSCXN Series - Stainless Steel

## COMMERCIAL OEM PUMPS



**SSCXN Series Centrifugal Pumps are designed for Commercial OEM applications, providing efficient performance, long service life and quiet trouble-free operation.**

**Motors are designed for high ambient temperatures/ high humidity environments, ideal for installation in OEM equipment with limited ventilation.**

**Closed-Cap Motor does not require a fan for cooling and is sealed from moisture and contaminated ventilated air. Powder coated finish provides superior corrosion resistance.**

## APPLICATIONS

Water System Booster  
Chemical Distribution  
Wash Systems  
Reverse Osmosis  
Filtration  
Water Conditioning & Treatment  
Water Heating Systems  
Aggressive & Corrosive Fluids

## SPECIFICATIONS

**Pump Body** – Stainless steel  
**Impeller** – Noryl  
**Multiple Seal Options**

## FEATURES

### **Heavy-Gauge Stainless Steel Housing –**

Provides a robust design for demanding OEM applications. Stout suction and discharge connections provide strength and resist pipe deflection. Abrasion and corrosion resistant NORYL impellers provide efficient performance and smooth flow path assures quiet operation.

**High Temperature Rating –** The SSCXN Series centrifugal pumps are designed for temperatures up to 185°F.

**Multiple Seal Options –** Choice of three seal options to meet a wide variety of pump applications.

- Buna carbon/ceramic
- Viton carbon/silicon-carbide
- Viton silicon-carbide/silicon-carbide
- Volute O-ring Matched to Seal
- Other Seal options available
- 

**NORYL® Composite Impeller –** Precision molded for perfect balanced for efficient ultra-smooth flow. Corrosion resistant for most chemicals, acids, and alkaline solutions. Rated for fluids up to 185°F. 304SS impeller insert for increased durability.

**Drain/Vent Ports –** Priming and draining is easier, faster.

**Max. Operating Pressure –** 125 PSI



# BERKELEY® SSCXN Series - Stainless Steel

ORDERING INFORMATION								
MODEL NUMBER	CATALOG NUMBER	HP	SUCTION	DISCHARGE	MOTOR VOLTAGE	PHASE	ENCLOSURE	APPROX. WT. LBS.
SS1XN-1/2	B78635	1/2	1-1/4"	1"	115/230	1	ENCLOSED	29
	B78636				230/460	3	ENCLOSED	29
	B78647				115/230	1	TEFC	32
	B78648				230/460	3	TEFC	32
SS1XN-3/4	B78637	3/4	1-1/4"	1"	115/230	1	ENCLOSED	38
	B78638				230/460	3	ENCLOSED	38
	B78649				115/230	1	TEFC	41
	B78650				230/460	3	TEFC	41
SS1XN-1	B78639	1	1-1/4"	1"	115/230	1	ENCLOSED	47
	B78640				230/460	3	ENCLOSED	47
	B78651				115/230	1	TEFC	50
	B78652				230/460	3	TEFC	50
SS1XN-1-1/2	B78641	1-1/2	1-1/4"	1"	115/230	1	ENCLOSED	62
	B78642				230/460	3	ENCLOSED	62
	B78653				115/230	1	TEFC	65
	B78654				230/460	3	TEFC	65
SS1-1/4XN-2	B78643	2	1-1/2"	1-1/4"	230	1	ENCLOSED	77
	B78644				230/460	3	ENCLOSED	77
SS1-1/4XN-2-1/2	B78645	2-1/2	1-1/2"	1-1/4"	230	1	ENCLOSED	90
	B78646				230/460	3	ENCLOSED	90

## PUMP PERFORMANCE

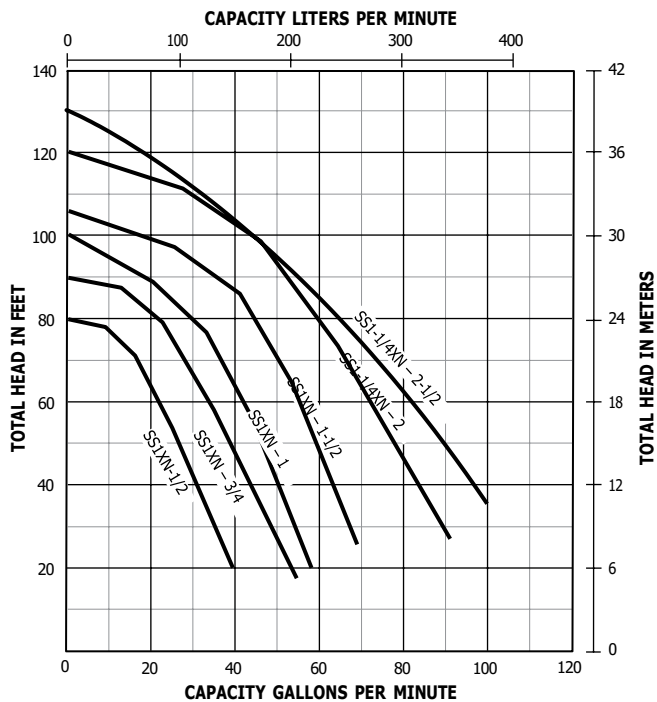

# BERKELEY® SSCXN Series - Stainless Steel

## OUTLINE DIMENSIONS

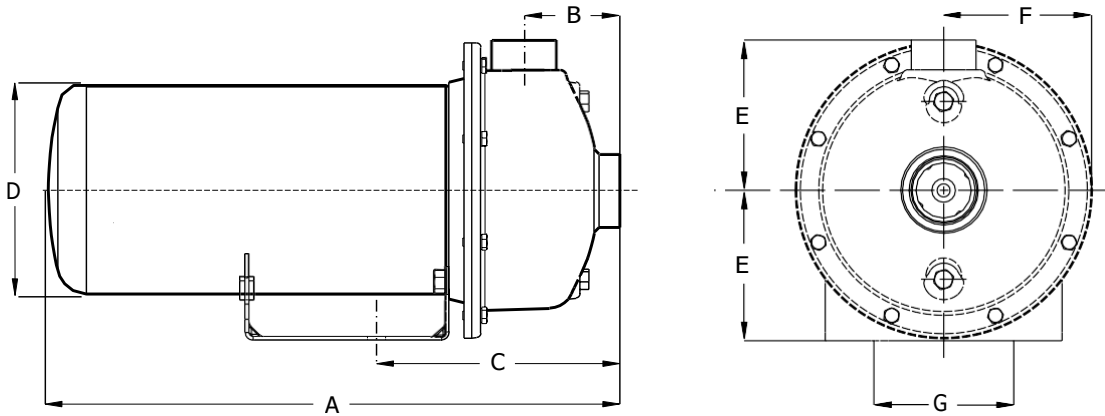

Dimensions (in inches) are for estimating purposes only.

### DIMENSIONS IN INCHES - SSCXN OPD

HP	NPT Suct.	NPT Disch.	A (1 phase)	A (3 phase)	B	C	D	E	F	G
1/2	1-1/4	1	13.2	13.5	2.43	6.51	5.63	4.13	4.06	4.875
3/4	1-1/4	1	13.2	13.5	2.43	6.51	5.63	4.13	4.06	4.875
1	1-1/4	1	14.2	14.0	2.43	6.51	5.63	4.13	4.06	4.875
1-1/2	1-1/4	1	14.5	14.5	2.43	6.51	5.63	4.13	4.06	4.875
2	1-1/2	1-1/4	16.0	15.7	2.63	6.71	5.63	4.13	4.06	4.875
2-1/2	1-1/2	1-1/4	16.9	16.4	2.63	6.71	5.63	4.13	4.06	4.875

### DIMENSIONS IN INCHES - SSCXN TEFC

HP	NPT Suct.	NPT Disch.	A (1 phase)	A (3 phase)	B	C	D	E	F	G
1/2	1-1/4	1	14.0	14.2	2.43	6.51	6.44	4.13	4.06	4.875
3/4	1-1/4	1	14.9	14.2	2.43	6.51	6.44	4.13	4.06	4.875
1	1-1/4	1	15.7	15.2	2.43	6.51	6.44	4.13	4.06	4.875
1-1/2	1-1/4	1	16.2	15.2	2.43	6.51	6.44	4.13	4.06	4.875



**293 Wright Street  
Delavan, WI 53115  
USA  
Ph: 888-782-7483  
Orders Fax: 800-426-9446**

**490 Pinebush Road  
Unit 4, Cambridge  
Ontario N1T 0A5  
Canada  
Ph: 800-363-7867  
Orders Fax: 888-606-5484**

**[www.BerkeleyPumps.com](http://www.BerkeleyPumps.com)**

Because we are continuously improving our products and services, Pentair reserves the right to change specifications without prior notice.

CB2051WS (07/02/18) ©2018 Pentair plc. All Rights Reserved.