

BERKELEY® B3ZRM HEAVY DUTY PUMPS

- Dimensionally interchangeable with the standard design
- Incorporates ten of the industry's best product features
- Provides the best operating and maintenance benefits available

Features / Benefits

- ▶ **Heavy-duty Bearing Frame**
Dimensionally interchangeable with the Standard Bearing Frame. Designed to maximize LT bearing life.
- ▶ **Sealed Bearings**
No in-field greasing is required. Keeps dirt and debris out of bearing.
- ▶ **Improved Bearing Retention Method**
Allows for extended dependability with minimal maintenance.
- ▶ **O-Ring Casing Seal (vs. Gasket)**
Better sealing method, more convenient for assembly/disassembly; allows easy rotation.
- ▶ **Hefty 1-1/4" Keyed Impeller Shaft**
Delivers excellent reliability and durability under all types of operating conditions. Offers easier removal and reduces shaft kit inventory for repairs.
- ▶ **416 S.S. Slip-fit Shaft Sleeve**
Offers safer, faster and easier maintenance. Sleeve installation does not require a torch, heat or cooling time, which can cause sticking or galling of the shaft.
- ▶ **Cast Iron Impellers**
Fine grained and precision cast to ASTM A48 Class 30.

▶ Casing

Available in CW and CCW models, with either NPT, Flanged or Victaulic connections. Casing can be rotated every 45 degrees for convenient mounting.

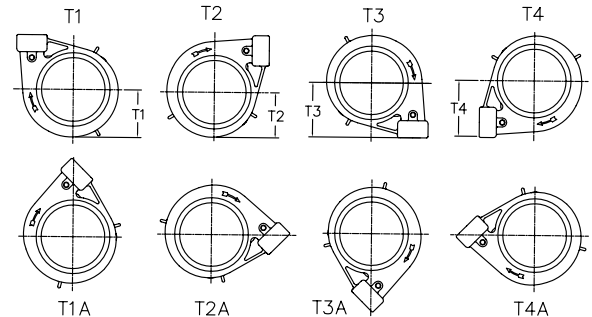

Note: Options T1A - T4A are rotated 45° from T1 - T4.

▶ Packed Stuffing Box Design

2-piece packing glands; large opening is easily accessed on either side for improved serviceability.

▶ Improved Bolt Clearance

More working room for easier installation.



BERKELEY® B3ZRM

Materials of Construction

| Part Name | Material | Spec Number |
|-----------------|-----------------------------------|-------------------|
| Volute Case | Cast Iron | ASTM A48 Class 30 |
| Impeller | Cast Iron | ASTM A48 Class 30 |
| Adaptor Bracket | Cast Iron | ASTM A48 Class 30 |
| Shaft Sleeve | 416 S.S. | AISI 416SS |
| Packing | Graphite impregnated PTFE packing | |

Pump Size: 3 x 4 x 9 M

9" Diameter Impeller

Nominal RPM: VARIOUS

Based on Fresh Water @ 68 deg. F.

Maximum Working Pressure: 266 PSI

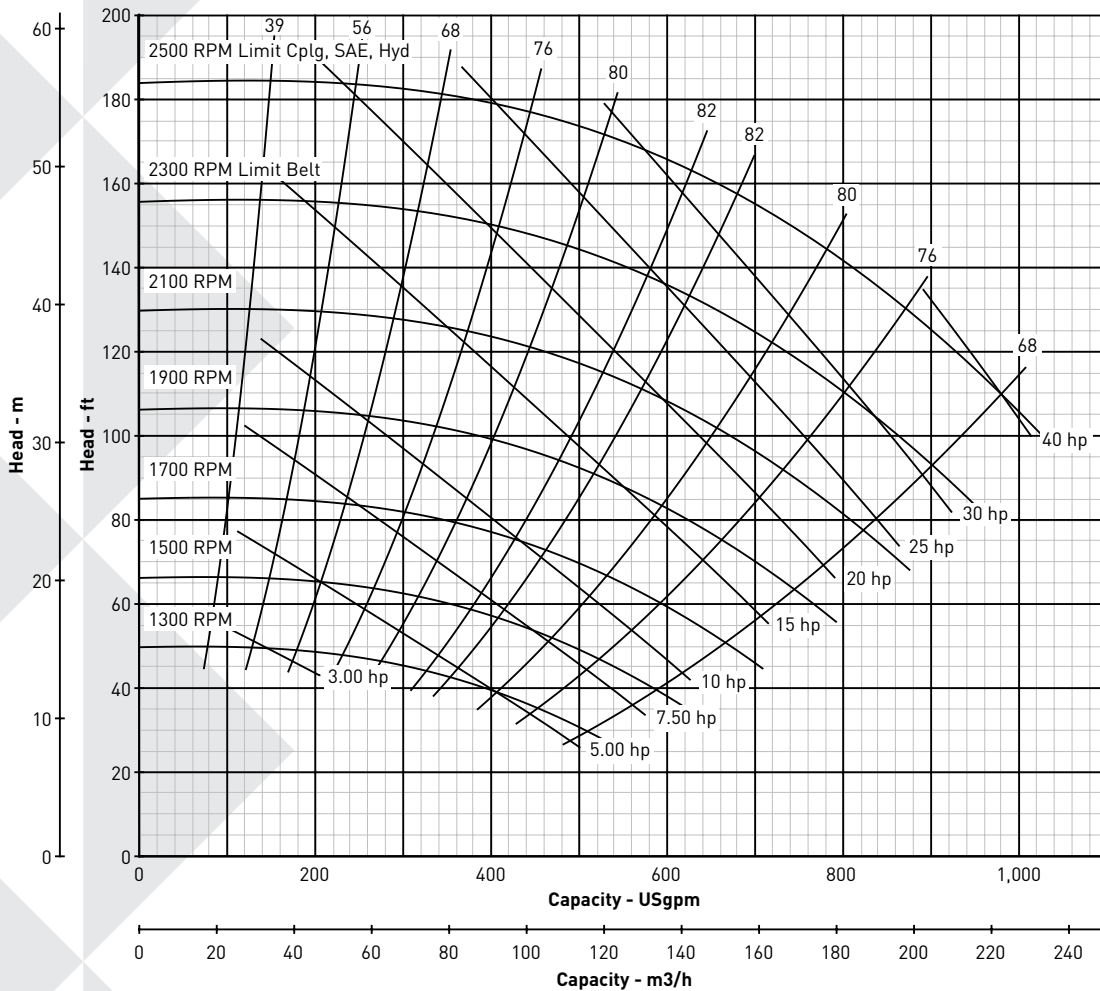

293 WRIGHT STREET, DELAVAN, WI 53115 WWW.BERKELEYPUMPS.COM
 PH: 888-237-5353 ORDERS FAX: 800-321-8793

Because we are continuously improving our products and services, Pentair reserves the right to change specifications without prior notice.

© 2012 Pentair Ltd. All Rights Reserved.

B2230BK (11/07/12)